



YACHT CLUB COSTA SMERALDA



**ROLEX SWAN CUP 2016**

**SAILING INSTRUCTIONS  
PORTO CERVO, 11<sup>th</sup> - 18<sup>th</sup> SEPTEMBER**



**PLEASE NOTE** that separate instructions are being issued for the Swan 45 World Championship. However, for the information of competitors in the Rolex Swan Cup, there are references to the Swan 45 Class in these instructions.

## 1 Refer to the Notice of Race

- 1.1 **Rules**, refer to paragraph 2 and Swan 42 OD Class Rules. This regatta is a Class 42 sanctioned event and is an inshore event under Class Rule 9.4 (sails allowed under Class Rule 6.2.1 as modified for this regatta shall be used). Inshore sails shall be used for all racing. ORCs applies to Class A Maxi.
- 1.2 **Advertising & Identification Numbers**, refer to paragraph 3 and Appendix DELTA of the SI.
- 1.3 **Eligibility & Classes**, refer to paragraph 5 and NoR Amendment N°1.
- 1.4 **Registration**, refer to paragraph 9.
- 1.5 **Scoring**, refer to paragraph 11. NoR 11.2 applies to Class A1 Mini Maxi.
- 1.6 **Disclaimer**, refer to paragraph 19.
- 1.7 **Media Releases**, refer to paragraph 20.
- 1.8 **Insurance**, refer to paragraph 21.
- 1.9 **Trophies & Prizes**, refer to paragraph 22.

## 2. Venue

2.1 Race Headquarters will be located at the YCCS Clubhouse. The Official Notice Board (ONB) and the YCCS Race Office will be located in front of the entrance of the YCCS Clubhouse on Piazza Azzurra. The Club Swan Office will be located in the Regatta Village on Piazza Azzurra.

2.2 Signals made ashore shall be displayed on the official flag staff located at the terrace of the YCCS Clubhouse.

## 3. Skipper's Briefing

The official Skipper's Briefing will be held at the YCCS Piazza Azzurra at 18.00 on 12<sup>th</sup> September, 2016. One representative per boat is requested.

## 4. Notices to Competitors and Changes to the Sailing Instructions

4.1 Notices to competitors will be posted on the ONB located in the Piazza Azzurra in front of the entrance of the YCCS clubhouse.

4.2 Any change to the sailing instructions will be posted before 09.30 on the day it will take effect, except that any change to the schedule of races will be posted by 20.00 on the day before it will take effect.

4.3 It is the responsibility of competitors to acquaint themselves with these notices. A copy of each amendment will be available at the Race Office and placed in each boat's mailbox, located in the Race Office.

4.4 The race committee will broadcast its intent for the day's racing at 09.30 daily on VHF channel 72.

## 5. Signals Made Ashore

5.1 The display or removal of signals will be indicated by a sound signal and will be announced on VHF Channel 72 when the race committee, at its discretion, considers it appropriate to do so.

5.2 Code flag "AP" (Answering Pennant) means: "the race is postponed". When flag AP is displayed ashore, '1 minute' is replaced with 'not less than 60 minutes' in the race signal AP.

## 6. Programme

6.1

Sunday 11 <sup>th</sup> September	13.00 – 18.00	Registration, measurements and free practice day
Monday 12 <sup>th</sup> September	09.00 – 16.00	Inspection, registration, measurements and free practice day
	18.00	Skipper's Briefing at the YCCS Piazza Azzurra
Tuesday 13 <sup>th</sup> September	Race(s)	
Wednesday 14 <sup>th</sup> September	Race(s)	
Thursday 15 <sup>th</sup> September	Race (s)	
Friday 16 <sup>th</sup> September	Lay Day or Re-sail	
Saturday 17 <sup>th</sup> September	Race(s)	
Sunday 18 <sup>th</sup> September	Race(s)	
	17.30	Final prize giving at the YCCS Piazza Azzurra

6.2 The scheduled time of the warning signal for the first Swan class each day will be 11.30. The racing format (coastal or windward/leeward) and the starting sequence each day for all classes will be posted on the ONB by 20.00 on the evening prior to racing.

6.3 The organizing authority and/or the race committee reserves the right to modify the programme based on weather conditions and/or for other unforeseen reasons.

6.4 If the race committee intends to hold an additional windward/leeward race the same day, a race committee boat near the finishing line will display Code Flag G. For multi race days, the warning signal for the additional race will be made one minute after the lowering of Code Flag "G" (with one sound), as soon as practical after the conclusion of the previous race.

6.5 In the event of a second coastal race, there will be a race committee Service Boat in the vicinity of Mark Zulu displaying Code Flag "G". The race committee will inform competitors of the start location for the second race on VHF channel 72.

6.6 On Sunday, 18<sup>th</sup> September there will be no warning signal after 14.30, except as a consequence of a general recall.

## 7 Finishing in Restricted Visibility

When a boat finishes at night or in restricted visibility she shall light her sail number using a powerful light or her spreader light and notify the race committee on VHF channel 72 when within 0.5nm of the finishing line.

## 8 Classes

8.1 Boats participating in the Rolex Swan Cup 2016 and the Rolex Swan 45 World Championship shall be divided into 6 Classes. The classes below are provisional and may be changed with a notice posted on the ONB after the close of registration on Monday, 12<sup>th</sup> September until 17.00.

### 8.2 CLASSES

		<u>CLASS FLAG</u>
A	Swan Maxi	Maxi Class Flag
A1	Swan Mini Maxi	Maxi Class Flag & Blue Flag
B	Swan Grand Prix	White Flag
C	Sparkman & Stephens	S&S Class Flag
D	Swan 45 OD	Swan 45 Class Flag
E	Swan 42 OD	Swan 42 Class Flag

## 9 Sail Numbers and Class Flags

9.1 Each boat shall display her sail number on the mainsail.

9.2 Boats shall display a bow number (with a banner for classes A, A1, B and C / a sticker for classes D and E) provided by the organizing authority on both sides of the forward part of the boat. Boats not identified or improperly identified may not be scored without a hearing. This changes RRS A4 and A5.

9.3 Boats participating in the Rolex Swan Cup 2016 shall display their class flag on the backstay at least 2 metres above the deck as indicated in SI 8.2.

9.4 Refer to SI Appendix DELTA for flag, pennant, sticker and number positioning.

## 10. Courses, Marks and Areas that are Obstructions

10.1 Coastal courses are described in Appendix Bravo Edition 2016 – (separate booklet in the captains' pack and published on the [YCCS website](#).)

10.2 Windward/leeward courses (for the Swan 45 and Swan 42 classes) are described in Appendix ALPHA.

10.3 Courses for both windward/leeward races and the coastal races will be signalled to competitors from the race committee vessel by displaying on the course board the number of the selected course before or at the warning signal for each category.

10.4 Marks of the course:

(a) The marks for coastal courses are described in Appendix Bravo Edition 2016. Marks laid by the race committee will be yellow inflatable buoys, except for Mark Bravo and Mark Zulu that will be red.

(b) Marks laid by the race committee for windward/leeward courses, will be yellow inflatable buoys except for marks for a change of course, which will be red.

10.5 For windward/leeward races, if a gate mark is missing, boats shall leave the remaining mark to port (this changes RRS 34).

10.6 Areas that are ranked as obstructions are described in Appendix Bravo Edition 2016, section 2.5 (Prohibited Passages).

## 11. Official, Press, and Support Boats

11.1 The race committee boat will be identified by a large burgee of the YCCS. The race committee boat will normally be the starting boat.

11.2 Service boats will be identified by a white flag with the letter "S".

11.3 Jury boats will be identified by a white flag with the letter "J".

11.4 Vessels used by press, photographers, film crews, VIP's, etc. are not under the jurisdiction of the race committee but may be identified by displaying a white flag with the letter "P".

11.5 All support boats shall register with the organizing authority before the start of the first race of the regatta and where possible display the flag supplied by the organizing authority. All support boats shall keep well clear of the starting area and, after the preparatory signal, are not to approach within 100 metres of any competing boats. Support boats should not interfere with any boat racing. Penalties for interfering shall be assigned to the respective boats and shall be at the discretion of the international jury.

## 12 The Start

12.1 Races will be started in accordance with RRS 26.

12.2 The starting line will be located within approximately four nautical miles of the entrance to Porto Cervo harbour. The starting line will be between staffs displaying orange flags on the race committee boat at the starboard end of the line and a service boat at the port end. The service boat at the port end may be replaced by a yellow inflatable buoy. The race committee boat and the service boat may hold their position with the use of their engines.

12.3 Boats whose warning signal have not been displayed shall avoid the starting area during the starting sequences for other classes.

12.4 The scheduled time of the start for the first class each day will be 11.35.

12.5 The starting sequence may change depending in part on whether the Swan 45 and Swan 42 classes will be sailing windward/leeward courses. The race course format and starting sequence for each race will be posted on the ONB by 20.00 on the evening prior to racing.

12.6 Competitors that do not leave the harbour are requested to notify the Race Office before 11.00. Competitors that leave the harbour but do not start are requested to notify the race committee by radio as soon as possible after the start of her class.

## 13 Time Limits

### 13.1 Coastal Courses

The time limit is 19.30. If at least one boat of each class completes the course within the time limit, all other boats in that class which finish the course within 120 minutes after the finish of the first boat of their class shall be scored. Boats not finishing within the time limit shall be scored one point more than the last boat finishing within the time limit and will not be penalized further. The scoring abbreviation for this will be **TLE** (**T**ime **L**imit **E**xpired) This changes RRS 35, A4, A5 and A11.

### 13.2 Windward/Leeward Courses

The time limit for windward/leeward courses shall be 2 hours. Boats failing to finish within 30 minutes after the first boat sails the course and finishes will be scored **Did Not Finish** without a hearing. This changes RRS 35, A4 and A5.

## 14. Retirement

A boat that retires from a race shall notify the race committee by hailing or by radio on VHF channel 72 before leaving the race area, or by notifying the Race Office promptly after arriving ashore.

## 15. Protests

15.1 Protest forms are available at the Race Office. Protests shall be delivered there within the protest time limit, which for each class is 90 minutes after the finish of the last boat in that class on the last race that day. Boats finishing after 19.30 shall lodge protests between 08.30 and 09.30 the following morning.

15.2 The Schedule of Hearings will be posted on the ONB not later than 30 minutes after the end of the protest time limit. Protest hearings will start as soon as possible after the notices are posted. Representatives of boats which are parties to a hearing or named as witnesses shall remain on call in the vicinity of the Jury Room located at YCCS Clubhouse. For the Islands Long Race there will be no hearings before 16.00 on the following day unless the parties agree otherwise.

15.3 It is the responsibility of each boat to check the Schedule of Hearings to see if she is cited in a protest. Failure of any boat to appear when called for a hearing may be considered by the International Jury as ground for proceeding under RRS 63.3 (b).

15.4 For infringements of rules other than the rules of RRS Part 1 and Part 2, the International Jury may apply any penalty including no penalty.

15.5 On the last day of the regatta:

15.5.1 A request for reopening a hearing shall be delivered:

(a) within the protest time limit if the party requesting reopening was informed of the decision on the previous day;

(b) no later than 30 minutes after the party requesting reopening was informed of the decision on that day. This changes rule 66.

15.5.2 A request for redress from a Jury decision shall be delivered no later than 30 minutes after the decision was posted. This changes rule 62.2.

15.6 Decisions of the International Jury will be final as provided in RRS 70.5.

15.7 For the Swan 42 class only, the Classification Protest Time Limit will be at the close of the scheduled official protest time on the first day of racing.

#### **16. Rating and/or Measurement Protests**

16.1 The final rating list and class assignment will be posted on the ONB after 1600 on Monday 12<sup>th</sup> September. Changes to the rating values for classes A, A1, B and C after 16.00 on Monday, 12<sup>th</sup> September will only be accepted at the discretion of the ORC Rating Authority.

16.2 Boats may not protest another boat in respect of an allegation that a measurement stated in that boat's measurement certificate is wrong unless the Measurement and Rating Committee (MRC) certifies that such measurement can be checked without delay. Any other such question shall only be resolved through the procedure set out in the ORC rules. This changes RRS 60.1 and 62.

16.3 Subject to SI 16.2 protests by competitors regarding a boat's rating, measurement and/or class assignment shall be lodged within 4 (four) hours after posting of the final rating list on Monday, 12<sup>th</sup> September. Rating and measurement protests shall be accompanied by a deposit of Euro 1.000,00 for each protested boat. The protest shall indicate the matters to be examined. If the protest has no basis the deposit will be forfeited towards the inquiry expenses; if it is well-founded the deposit will be refunded and any expenses will be paid by the protesting boat. This changes RRS 64.3 (d).

#### **17. Penalties and OCS**

17.1 In Classes A (Swan Maxis), A1 (Swan Mini Maxi), B (Swan Grand Prix) and C (Sparkman & Stephens) the scoring penalty, RRS 44.3, will apply instead of the one turn and the two turns penalties. Code Flag "I" is acceptable as a yellow flag (changing Rule 44.3). A boat that accepts a scoring penalty shall receive points equal to three places added to her actual finishing position. However she shall not be scored worse than "**Did Not Finish**". The Turns Penalty, rule 44.1 and 44.2, shall not apply.

17.2 A boat in Class A, A1, B or C that is OCS may either return to the start and start correctly in accordance with rule 28 or have 15 minutes added to her finishing time, without a hearing. If a boat takes the time penalty, rules 28.1, 29.1 and A4.2 and A5 are changed. This Sailing Instruction shall only apply if the boat concerned has manoeuvred in the vicinity of the start line and has genuinely attempted to start and has failed to do so.

17.3 For Class E (Swan 42) only, RRS 44.1 and 44.2 are changed so that, except for infringements of the rules of Part 2 that occur within the zone of a rounding mark or finishing mark, only one turn, including one tack and one gybe, is required.

17.4 Jury boats may be at sea observing the races.

17.5 For infringements of rules other than the rules of RRS Part 1 and Part 2, the International Jury may apply any penalty including no penalty.

17.6 Exoneration Penalty:

a) A boat that may have broken a rule of RRS Part 2 or RRS 31 may, after finishing the race concerned and before the start of a related protest hearing, notify the race committee that she accepts an Exoneration Penalty – a scoring penalty of points equal to six places in accordance with RRS 44.3, except that she shall not be scored worse than "**Did Not Finish**". However, if the boat caused injury or serious damage or, despite taking a penalty, gained a significant advantage in the race or series by her breach her penalty shall be to retire.

b) When an Exoneration Penalty is accepted:

(i) Neither the boat nor the Jury may then revoke or remove the penalty.

(ii) The boat shall not be penalized further in a protest hearing when the Jury decides that it was appropriate to the facts found and the applicable rules.

17.7 Competitors shall notify the race committee as soon as practical after finishing if they have taken a scoring penalty and/or any intention to protest. Any penalty shall also be reported to the race office in writing (forms are available) within the protest time limit.

#### **18. Hauling Out and Repairs**

18.1 At 15.00 on Monday, 12<sup>th</sup> September all boats shall be launched at sea.

18.2 Boats shall not be hauled out during the regatta except with and according to the terms of prior written permission of the organizing authority. Cleaning and polishing below the waterline is not permitted when hauled out during the event.

18.3 Repairs and replacement of sails, equipment and hull parts damaged during a regatta shall not cause a boat to be re-measured until after the regatta is completed. Applications to replace or repair sails must be made to the organizing authority on the Sail Repair/Replacement Form available at the Race Office. No repair shall be carried out and no replacement shall be made after registration without the written consent of the organizing authority.

18.4 Cleaning of the hull and appendages below the waterline is prohibited at all times while afloat, either inside or outside the harbor. Italian law prohibits cleaning of the hull inside or outside the harbor. This is a protestable offense and the Organizer intends to actively enforce SI 18.4.

**19. Rating Certificates**

The list of rating values shall be issued by the Measurement Committee as soon as possible after 16.00 on 12<sup>th</sup> September, approved and signed by the organizing authority. Thereafter no changes of the rating values are possible unless as a consequence of controls and inspections and with the approval of the organizing authority.

**20. Measurement and Rating Committee**

20.1 As per Notice of Race section 4, a Measurement and Rating Committee (MRC) will be appointed. The MRC will conduct measurement and other checks and will advise the race committee of any breach. Depending on the breach, the race committee may protest the boat concerned.

The MRC will consist of one representative from each of:

- a) The ORC;
- b) Nautor's Swan;
- c) The Yacht Club Costa Smeralda.

The MRC may, at its discretion, co-opt additional technical advisers.

20.2 The MRC has the right to undertake random inspections and measurement checks on any competing boat throughout the regatta and registration period. All boats shall be available for inspection at any reasonable time. In the event of a protest, access for inspections may be requested at any time.

20.3 A cross section of competing boats will be checked soon after each race. Boats may be boarded on their way to and from the race area when conditions allow. Sails may need to be transported ashore for measurement check.

**21. Crew Lists**

21.1 A crew list with the names of each crew member shall be lodged at the Race Office by 16.00 on Monday, 12<sup>th</sup> September. Changes to the crew list shall be approved by the organizing authority and class representative for Swan 42 OD and Swan 45 OD classes and shall be made in writing indicating the name(s) of the substituting crew member(s) and shall be lodged at the Race Office before 09.30 of each day. Refer to SI Appendix CHARLIE for Italian Competitors.

21.2 The organizing authority may direct television crew to be on board a boat additional to the crew list. Other guests on board shall be on the list and shall comply with section 21 of these Sailing Instructions and Appendix CHARLIE if Italians.

**22. Communications**

22.1 The race committee will use VHF 72 to broadcast information which may include signals made ashore, location of the race committee boat, bow or sail numbers of boats recalled, change of course etc.. The initial daily announcement will be made on VHF Channel 72 at 09.30. A time check may be transmitted by the race committee on VHF Channel 72 approximately 30 minutes before the first warning signal each day race.

22.2 Failure by the race committee to transmit by radio the information referred to in the Sailing Instruction, errors, omissions or delay in doing so and failure by a boat to receive or hear such radio transmissions will not be grounds for request of redress. (Amends RRS 60.1 (b) and 62.1 (a)).

22.3 Except for weather forecasts, a boat shall neither make radio transmission while racing nor receive radio communications not available to all boats. Competitors shall not use any electronic device (including scanners), with the exception of cell phones, which can receive UHF frequencies from 10.30 until racing has concluded on each of the race days. See RRS 41. No competitor shall make radio, cell phone or computer transmissions, or receive radio, cell phone or computer communications during that time frame, except in the case of an emergency. The only other exception is that a crew member may place or receive a cell phone call of a personal nature that does not involve the exchange of information that could affect the boat's outcome in the race. The Skipper/Owner shall be responsible for all communications activity aboard his/her boat. Not complying with this instruction may be considered a gross breach of sportsmanship and will be dealt with accordingly. Nothing in this paragraph shall prevent internal communications by radio between crew members.

22.4 VHF channel 72 shall not be utilized by the boats except as indicated in SI 14 (Retirement), SI 17 (Penalties), or for safety reasons.

**23. Electronic Equipment & Trac Trac Device**

23.1 All types of electronic aids, including radar, GPS, etc., are permitted.

23.2 At registration each yacht will be issued a Trac Trac GPS tracking unit, with charger, that shall be attached to each yacht (see Appendix FOXTROT). It is mandatory for each yacht to recharge the unit every evening. Failure to do so will be reported to the race committee who may take action. The Trac Trac GPS tracking unit and charger shall be returned to the race office after the last race of the event.

**24. For Swan 42 Class only:**

Class Rule 27.2 is suspended if the race committee displays Race Signal AP over H until a boat leaves her mooring again or the race committee terminates racing for that day in either way.

---

**APPENDICES:**

<b>ALPHA:</b>	Windward / Leeward Courses
<b>BRAVO:</b>	Coastal and Island Courses ( <i>separate booklet</i> )
<b>CHARLIE:</b>	FIV Prescriptions (for Italians only)
<b>DELTA:</b>	Flag & Pennant Positioning
<b>ECHO:</b>	Emergency Procedures On Water
<b>FOXTROT:</b>	GPS Tracking System Instructions

---

**APPENDIX ALPHA | WINDWARD - LEEWARD COURSES**

**1. Selection of the Course**

1.1 The information will be arranged vertically. Example:

4	Course
300	Approximate magnetic bearing to Buoy 1
1.7	Approximate distance to Buoy 1 (nautical miles)

The accuracy of the approximate bearings and distances shall not be used as grounds for request of redress. This changes RRS 62.

1.2 (a) Mark 1 and 1a shall be rounded to port.

(b) When there is a gate, boats shall sail between the gate marks from the direction of the previous mark and round either gate mark;

(c) If only one Gate mark is set, boats shall round the single mark to port;

(d) The Gate may be laid after the starting signal;

(e) There will be a windward offset mark (1a);

(f) The leeward gate will be positioned approximately 200 -300 meters to windward of the center of the starting line and will be approximately 100 - 150 meters wide;

(g) The Finishing Line (leeward finishes) will be approximately 200 meters long with the race committee signal boat remaining in the same location as during the start (unless there is a change of course);

(h) The Finishing Line (windward finishes) will be approximately 200 meters long, and located approximately 200 meters to windward of the windward mark (unless there is a change of course).

**Upwind Finish** \_\_\_\_\_ **Race Committee Boat**



Start/downwind finishing mark



Race Committee Boat

**Course 4:** Start - 1 - 1a- 2s/2p - 1 - 1a - Finish (Downwind)

**Course 5:** Start - 1 - 1a - 2s/2p - 1 - 1a - 2s/2p - Finish (Upwind)

**Course 6:** Start - 1 - 1a - 2s/2p - 1 - 1a - 2s/2p - 1- 1a - Finish (Downwind)

**APPENDIX BRAVO | Coastal and Island Courses - A separate booklet delivered with the registration kit**

**APPENDIX CHARLIE | FIV PRESCRIPTION (for Italians only)**

**PART 6 - ENTRY AND QUALIFICATION**

**Rule 75 – ENTERING A RACE - Prescription to Rule 75.2**

The Italian Sailing Federation prescribes: “Current FIV regulations are to be followed when accepting entries; the competitors must hold a valid and current FIV Membership and the owners of boats of recognized classes, including offshore, must also hold a valid and current FIV Membership, even if they are not sailing the race.”



## APPENDIX DELTA | FLAG &amp; PENNANT POSITIONING

CLASS: A, A1, B &amp; C



CLASS: E (swan42 OD)

**MANDATORY:**

THE BETTER YOU PLACE THE STICKER, THE LESS CHANCE IT HAS OF FALLING IN THE WATER  
**DO IT PROPERLY FOR THE GOOD OF THE SEA**  
A WELL APPLIED STICKER SHOULDN'T TEAR OR PEEL OFF

1. Remove the salt from the bow with fresh water and clean with isopropylene alcohol.
2. Position the sticker and remove ¼ of the protective film.
3. Use a plastic card, such as a credit card, to expel any air all the way to the edge of the sticker.
4. Allow a minimum of 2 hours before going sailing.

Any attempt to reposition the sticker due to poor initial placement will reduce the solidity of the mounting. If this should occur, please ask the race office for a new sticker.

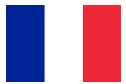

UNE APPLICATION CORRECTE DE L'AUTOCOLLANT ÉVITERA DE LE PERDRE DANS L'EAU  
**FAITES LE BON GESTE POUR LE BIEN DE LA MER**  
UN AUTOCOLLANT BIEN APPLIQUÉ NE SE DÉTACHE PAS

1. Enlevez le sel de la proue avec de l'eau douce puis nettoyez avec de l'alcool isopropylique.
2. Positionnez l'autocollant en retirant ¼ du film protecteur.
3. Utilisez une spatule en plastique, comme une carte de crédit, afin de retirer l'air présent sous toute la surface adhésive.
4. Attendre au moins 2 heures avant de naviguer.

Toute tentative de repositionnement de l'autocollant, suite à une erreur d'application, réduira la résistance de la colle. Le cas échéant, veuillez demander un nouvel autocollant à l'organisateur.



UNA CORRETTA APPLICAZIONE RIDUCE LA POSSIBILITÀ DI CADUTA IN ACQUA  
**FATE IL GESTO GIUSTO PER IL BENE DEL MARE**  
UN ADESIVO INCOLLATO BENE NON DOVREBBE STACCARSI

1. Togliete il sale dalla prua con acqua dolce e pulitela con alcool isopropilico.
2. Posizionate l'adesivo togliendo ¼ della pellicola protettiva.
3. Usate una spatola di plastica, come una carta di credito, per eliminare ogni bolla d'aria su tutta la superficie dell'adesivo.
4. Aspettate almeno due ore prima della navigazione.

Ogni tentativo di riposizionare l'adesivo a causa di un'errata applicazione riduce la resistenza dell'incollaggio. In tal caso, chiedete un altro adesivo all'ufficio gara.

**APPENDIX ECHO | EMERGENCY PROCEDURES ON WATER**

The YCCS, in conjunction with safety officials in Porto Cervo, has established emergency procedures to provide help in the event of an on the water emergency, including injury requiring medical assistance. We also have emergency numbers should there be an accident or injury on shore.

1. Contact the Race Committee immediately on VHF 72 or VHF 8. If unable to raise the race committee on VHF, call the race office.
2. Identify your yacht, the nature of the emergency (type of injury, number of people injured), and your yacht's position.
3. The Race Committee will alert on water safety boats (which will also be monitoring VHF 72) and may direct you to another VHF channel or cell phone for further communication.
4. Proceed at best speed to a designated rendezvous point as directed.
5. Depending on the nature and severity of the injury, should this be the emergency, safety boats personnel may come aboard your yacht to administer aid, evacuate the injured party and/or re-direct you for transfer of the injured person.
6. You are asked to cooperate fully with the Race Committee, local law enforcement and emergency personnel direction.

**Please take the time to review these procedures with your crew prior to the race.**

---

**EMERGENCY AND MEDICAL NUMBERS**

**Race Committee: VHF Channel 72 or VHF Channel 08**

**YCCS Race Office: Phone n. +39 333.48.583.85**

## APPENDIX FOXTROT | TRACKING SYSTEM INSTRUCTIONS

INTEGRATION TO SAILING INSTRUCTIONS

- 1 GPS tracking of individual boats will be used for safety purposes. In addition the organizers will use the Trac Trac system for public media purposes and to provide displays onshore.
- 2 The following safety procedure will be followed:
  - a) At registration, the boat Representative, shall personally collect and sign for their tracking device.
  - b) It is a boat Representative responsibility to **re-charge every evening** the tracking device. Every tracking device is provided with a 100/240V 50/60Hz micro USB charger.
  - c) The tracking device must be returned to the Race Office at the end of the last race of the series and before the Prize Giving.
  - d) Any boat failing to comply with this procedure, without any reason beyond her control, will be reported to the Race Committee and/or Protest Committee for possible action.

**PLEASE RETURN THE TRACKING DEVICE AND CHARGER TO THE EVENT ORGANIZER IMMEDIATELY FOLLOWING THE LAST RACE. IN CASE OF LOSS, THE COST WILL BE CHARGED.**

Tracking System Instructions

## DEVICE OPERATIONS

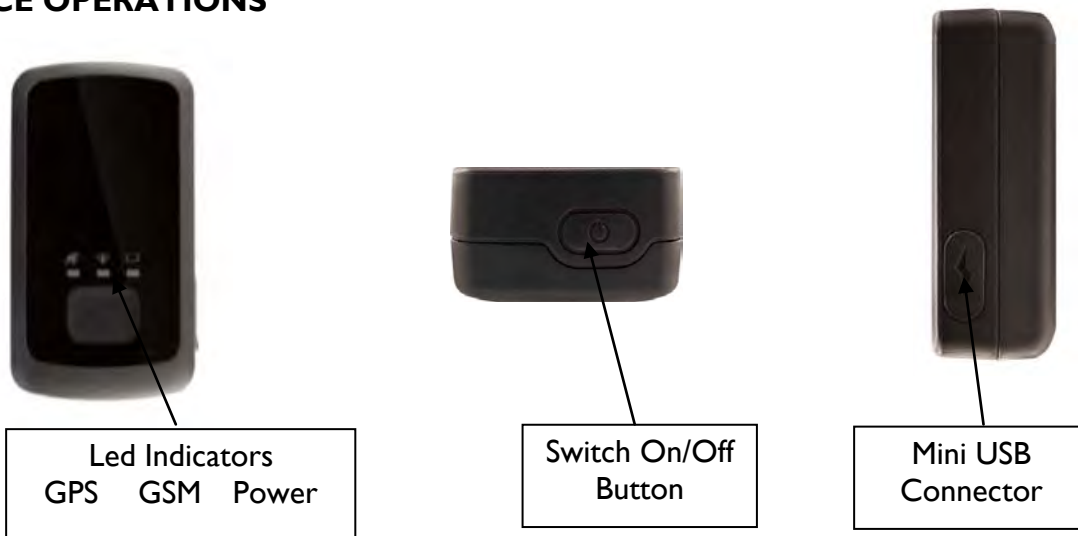
**SWITCHING ON/OFF**

Press the **Switch On/Off Button** for at least 3 seconds and release it to turn on.

If you wish to **switch off** the device, push and hold for at least 2 seconds the **Switch On/Off Button**. **Power LED** will fast flash and then turn off, it indicates that the unit is turned off.

### LEDs Description

LED	EVENT	STATE
GPS LED	GPS has fixed	Solid
	GPS is in fixing	Fast Flash
	GPS is off	Dark
GSMLED	Searching network	Fast Flash
	Network has been registered	Slow Flash
Power LED	Power on and normal	Dark
	Charger inserted and charging completed	Solid
	Charger inserted and charging	Fast Flash
	Power key was pressed and prepare to power off	Fast Flash
	Power low alert	Slow Flash